

City of Crescent City, California

BEACHFRONT PARK AND FRONT STREET Master Designs, Funding, and Progress Update





Beachfront Park



THE MASTER PLAN

PURPOSE OF A MASTER PLAN

- A 'road map' to guide future improvements
- Represents a 'big vision' that is reflective of community input
- An important tool to help acquire funding
- Usually implemented over many years in phases
- A compromise that balances community needs

DOWNTOWN CRESCENT CITY

rrm design group
making environments people enjoy



* Disc Golf Note:

Layout of 24-hole disc golf course is conceptual. Final hole layout will be determined in the field in conjunction with City staff and Disc Golf Club representatives. Some holes are outside the limits of this plan in Battery Park. Holes shall be a minimum length of 150', and maximum length of 700'.

Key to Park Features

- | | | | | |
|--|---|---|--|--|
| 1. Kayak rentals | 9. Marine Mammal Center | 17. Bandstand | 25. Horseshoe pits | 33. Planter area |
| 2. Park maintenance facility | 10. Sports hub - concessions, restrooms | 18. Pedestrian plaza with mobile vendor hookups | 26. Sand volleyball | 34. Howe Park East - level with top of levee |
| 3. Dog park (areas for small and large pets) | 11. Central pedestrian promenade | 19. Concessions/restrooms | 27. Basketball | 35. Bus stop/passenger drop-off |
| 4. Sports equipment storage | 12. Accessible pathway, typical | 20. Amphitheater/event space | 28. Putting green | 36. Botanical gardens |
| 5. Disc golf - 24 holes* | 13. Coastal trail - 12' wide waterfront promenade | 21. Overlook with public art focal point | 29. Kids Town expansion area | 37. Beach access |
| 6. Restroom - existing | 14. S.S. Emidio Memorial | 22. Levee realigned to widen beach | 30. Individual picnic shelter, typical | 38. Potential location for labyrinth |
| 7. Picnic area | 15. Town square | 23. Streetscape per Front Street Revitalization Plans | 31. Picnic lawn | |
| 8. Playing field | 16. Central plaza - for civic events, pastels in the park, roller derby, etc. | 24. Bocce courts | 32. Group picnic shelter | |

Conceptual Plan | BEACHFRONT PARK MASTER PLAN

March 2012

0' 30' 60' 120' 180' 240'





VEHICULAR CIRCULATION

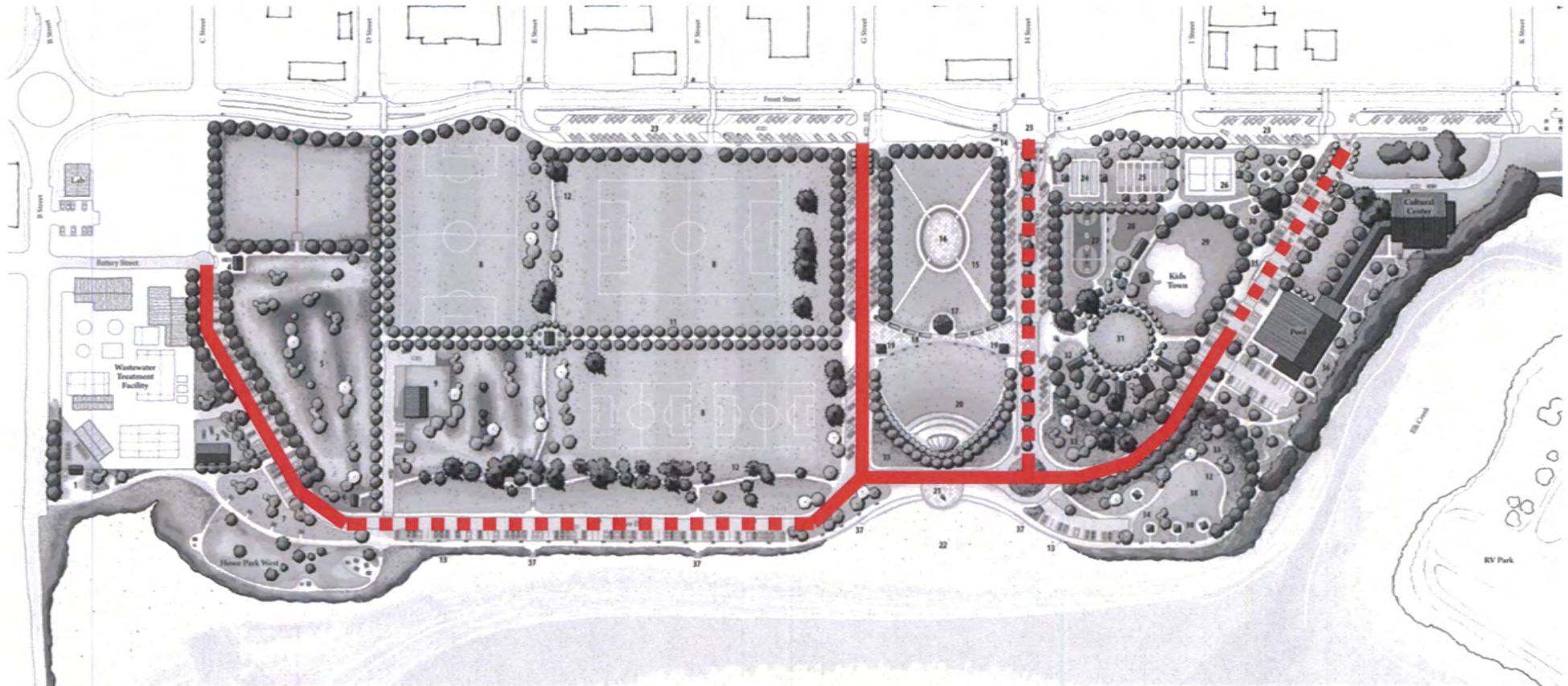

— = New road

--- = Existing road



PEDESTRIAN CIRCULATION

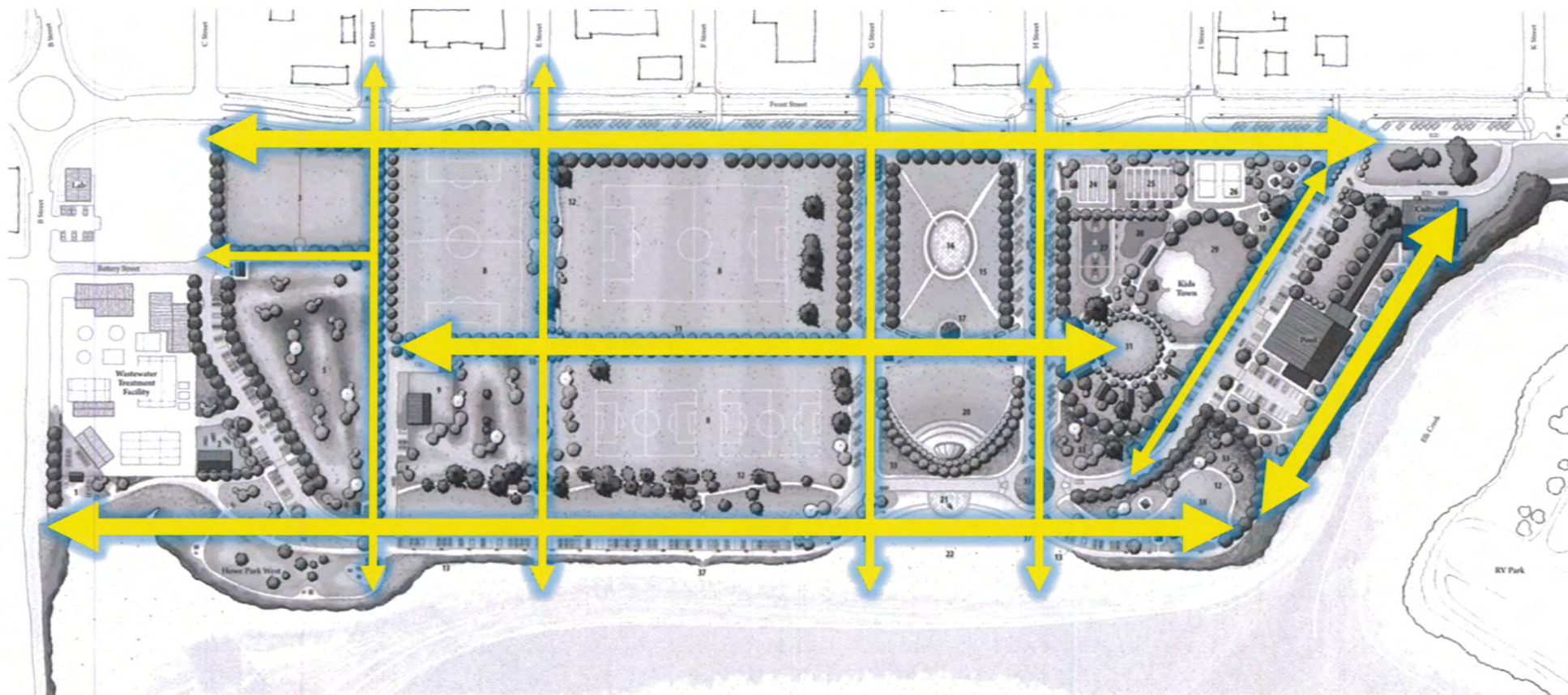



EAST END DETAIL





RECREATION AREA DETAIL





HOWE PARK EAST DETAIL





TOWN SQUARE & AMPHITHEATER





TOWN SQUARE & AMPHITHEATER DETAIL

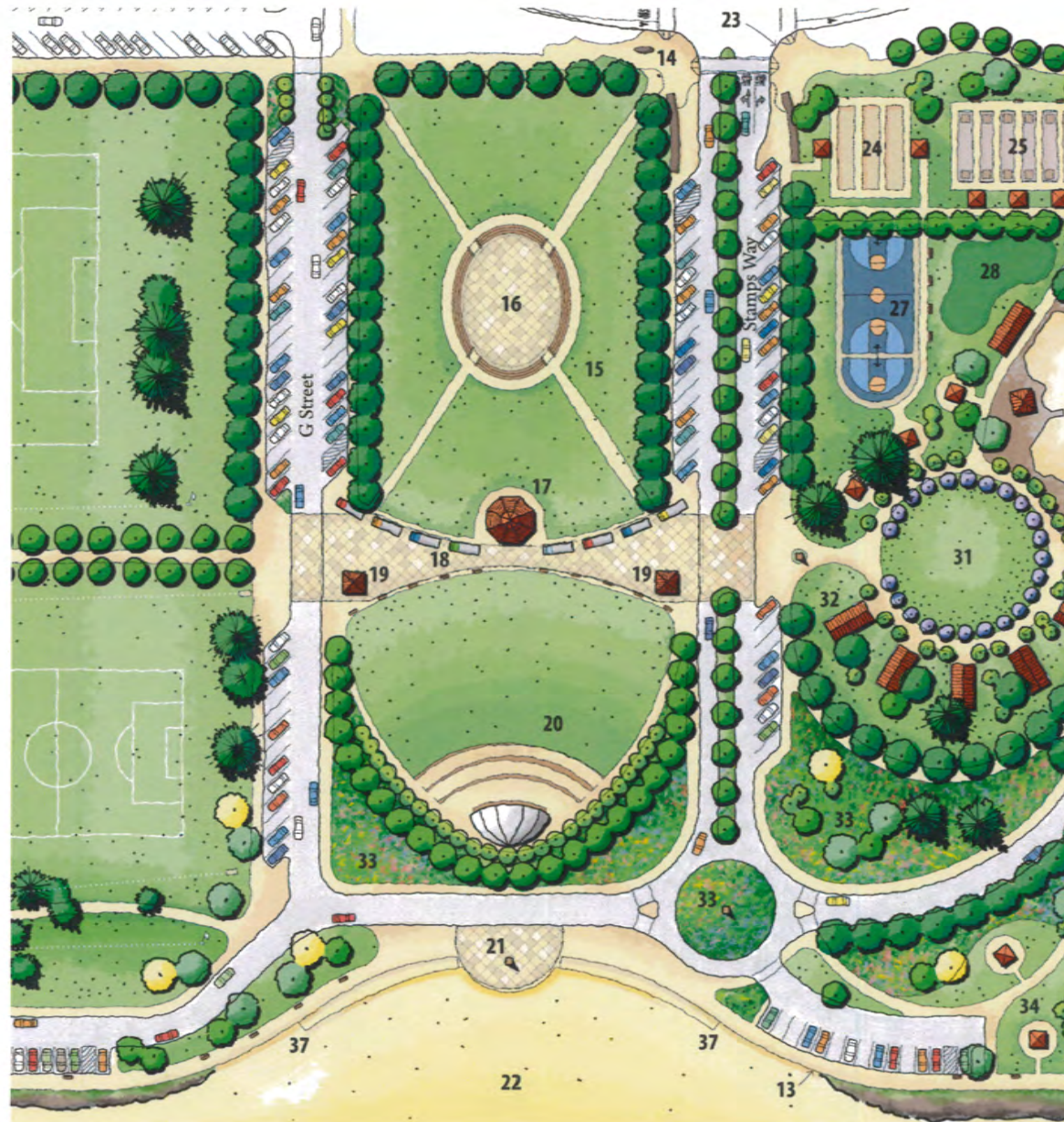



AMPHITHEATER & VENDOR PROMENADE





VENDOR PLAZA



Beachfront Park Fund Sub-Accounts

	Account Reference Number	Account Name	Key Features Included
1	BFP01	Amphitheater and Concessions	18, 19, 20
2	BFP02	Artistic Improvements	15, 21, all other
3	BFP03	Beach and Beach Access Improvements	7, 13, 22, 21, 37
4	BFP04	Bus Stop	35
5	BFP05	Disc Golf	5
6	BFP06	Dog Park	3
7	BFP07	Game Center	24, 25, 26, 27, 28, 29, 30,31,32,33
8	BFP08	General	2, 4, 6, all other needs
9	BFP09	Howe Park East	13, 30, 34, 33, 38
10	BFP10	Pedestrian and Access Improvements	11, 12, 13, 18
11	BFP11	Playing Fields	8, 10
12	BFP12	Street and Parking Improvements	All
13	BFP13	Trees/Beautification	All
14	BFP14	Town Square and Plaza	15, 16, 17

*Sub-accounts may be broken down into further sub-accounts upon request



Tsunami Way

OVERALL THEME



Tsunami Way

GATEWAY DESIGN



Tsunami Way

VIEW TRAVELING NORTH ON 101, OPTION 1



Tsunami Way

CLOSE UP OF WAVE SIGN



Tsunami Way

REVISED LIGHT HOUSE DESIGN, OPTION 2



Tsunami Way

VIEW TRAVELING SOUTH ON 101



Tsunami Way

GATEWAY ARCH



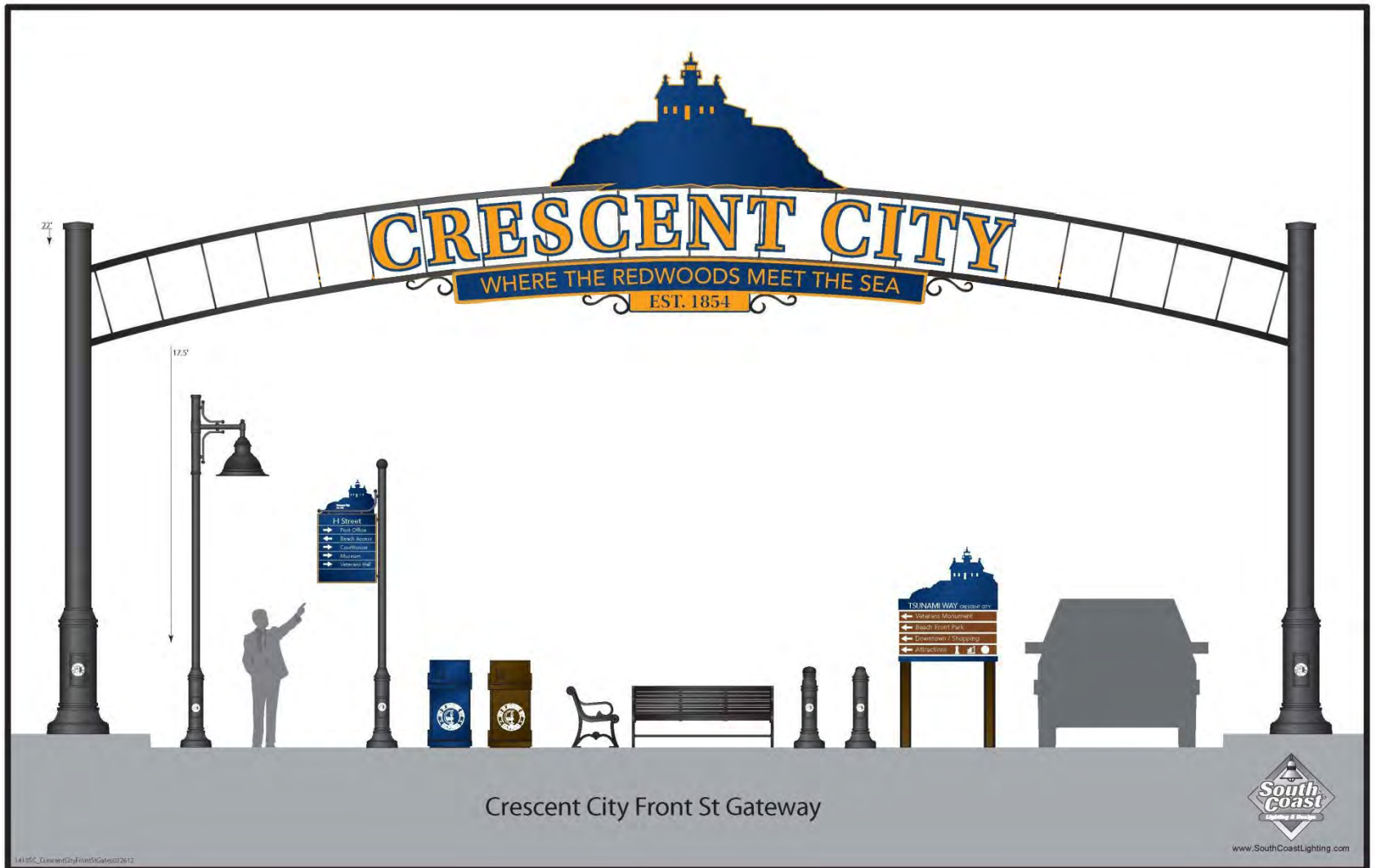

Tsunami Way

2. "THE BEACH"-INTERSECTION OF TSUNAMI WAY AND H ST.



Tsunami Way

WALL DETAIL

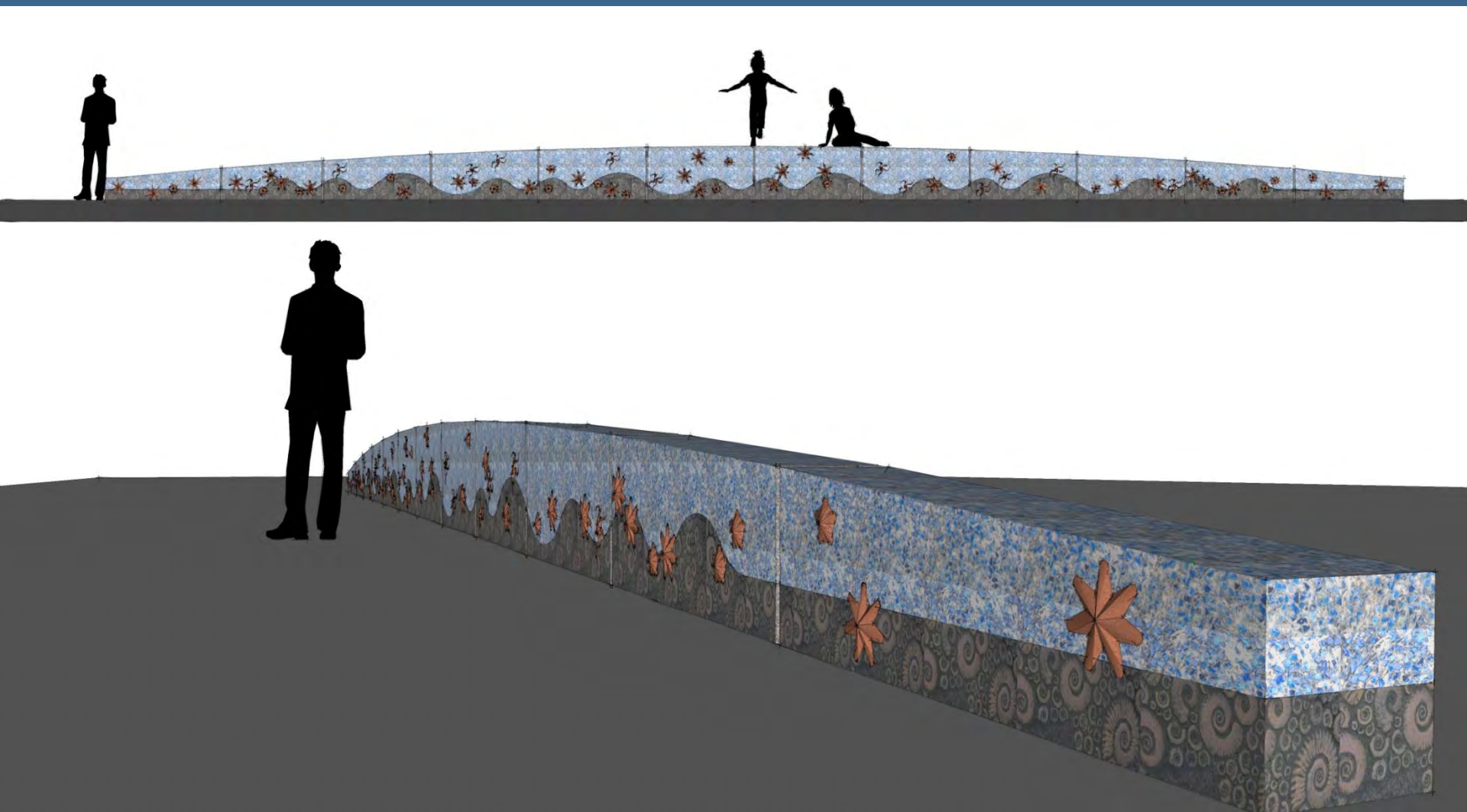

Tsunami Way

3. VIEW DOWN TSUNAMI WAY



Tsunami Way

4. DECORATIVE METAL FENCE AT F ST. CROSSING

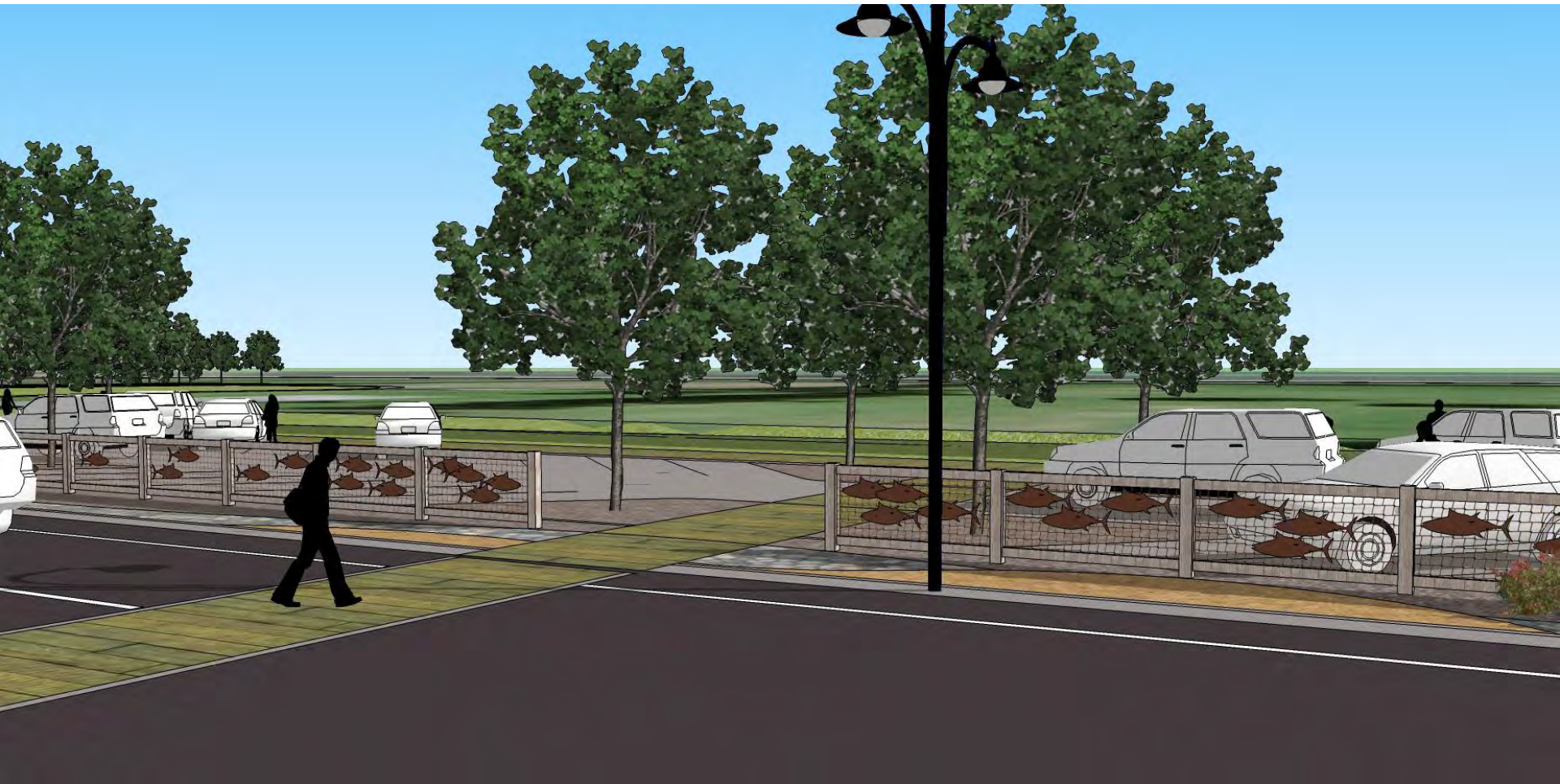

Tsunami Way

5. CRAB BOX SEATING AREA



Tsunami Way

8. VIEW LOOKING EAST



Tsunami Way

7. ROUNDABOUT WITH BREACHING WHALE



WAYFINDING SIGNAGE



US 101 Two Post Option



US 101 Single Post Option



Tsunami Way Street Sign

Crescent City WAYFINDING SIGNAGE

Pacific
Ocean



Crescent City
Wayfinding
Sign

Legend

Sign Locations

- ◆ New Signs
- Future Signs
- ◆ Points of Interest

— Tourist Routes

0 250 500 1,000 Feet

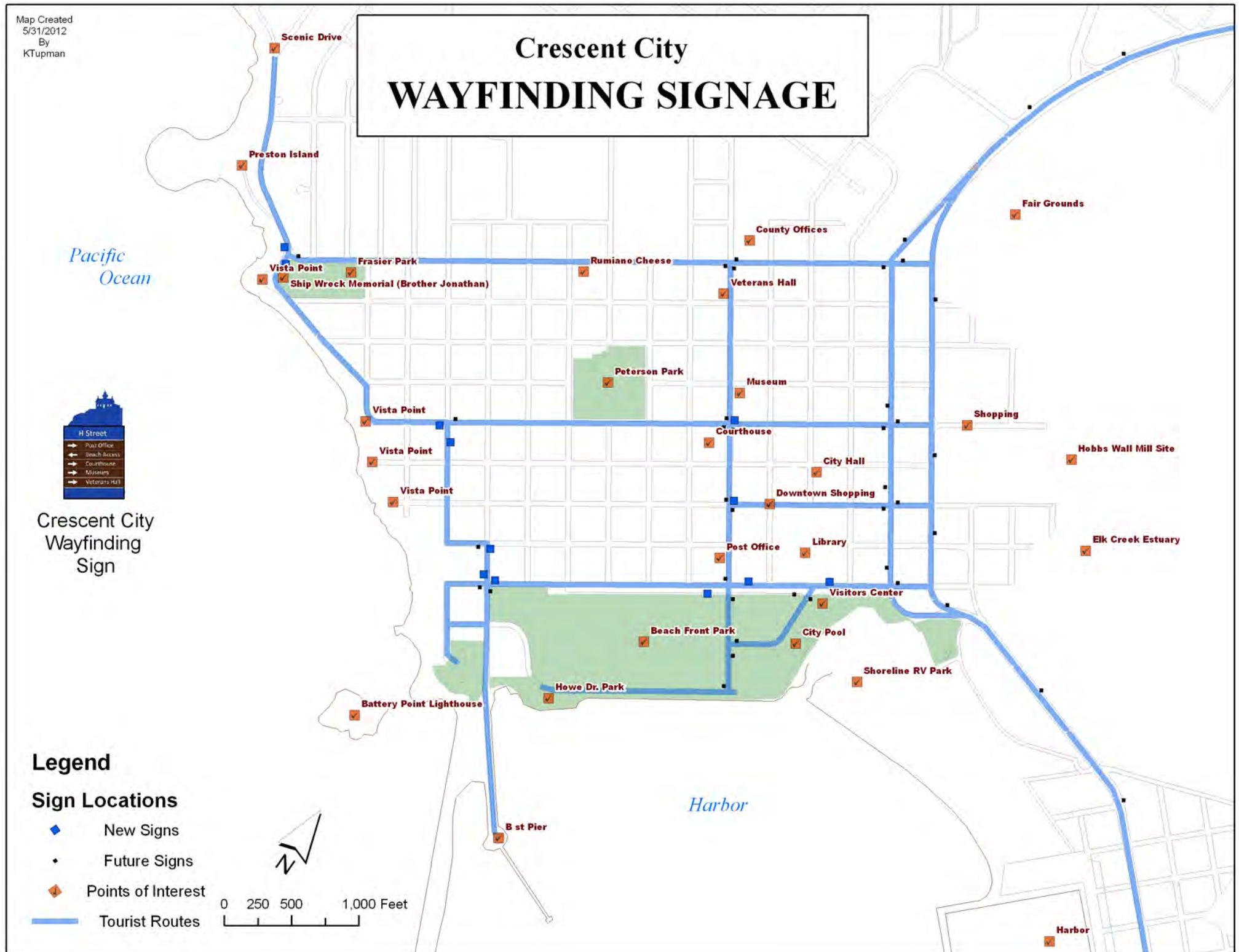

Tsunami Way

3. VIEW DOWN TSUNAMI WAY



FRONT STREET - TSUNAMI WAY -GATEWAY DESIGN

ESTIMATED COSTS

Pedestrian Improvements - \$3,000,000 - \$4,000,000

Water System - \$500,000 - \$750,000

Storm Drains - \$700,000 - \$900,000

Transit - \$200,000 - \$400,000

Roundabout - \$1,500,000 - \$2,000,000

Roadway Rehab - \$3,000,000 - \$4,000,000